

SMOKE, HEAT & CARBON ALARMS

BSI KITEMARKED ALARMS

Red Arrows latest professional range of Smoke, Heat & Carbon Monoxide alarms are all BSI kitemarked to ensure complete peace of mind for all property types. Choose between mains range with sealed or replaceable battery and RF/wired interconnect or battery range with replaceable battery and RF linking capabilities up to a maximum of 40 devices. Suitable for BS 5839-6:2019+A1:2020 Installations. Range of accessories including battery operated carbon alarm, remote controller and optional pattress kit.



Features

- Designed to detect and raise an alarm for smoke, heat or carbon monoxide gas
- Mains range includes sealed and replaceable battery options, with RF and wired interconnection
- Battery range includes replaceable battery and RF interconnection
- BSI Kitemarked for complete peace of mind
- Compliant to BS 5839-6:2019+A1:2020 Grade D1, D2 & F1
- Interconnect upto 40 devices
- All sensors are 100% tested, NOT batch tested

Specification

| Code | Description | Lumen Output | Emergency Lumen Output | Wattage | Efficacy |
|-----------------|-------------------------------------------------|--------------|------------------------|---------|----------|
| SHC-WIR-SM-10YR | Mains Operated Smoke Alarm 10yr Sealed RF/Wired | | | | |

Product Information

| | | | |
|-----------|---------|-----------|------|
| Guarantee | 5 Years | Frequency | 50Hz |
|-----------|---------|-----------|------|

| | |
|-------------------------|---------------|
| Voltage | 220 - 240V |
| Material (Body/Housing) | Polycarbonate |
| Colour Finish | White |

| | |
|---------------------|-------------|
| Approval | UKCA CE BSI |
| Electrical Class | Class II |
| Working Temperature | 0°C to 40°C |

ELECTRICAL

SPECIFICATION SHEET



SMOKE, HEAT & CARBON ALARMS

BSI KITEMARKED ALARMS

Packaging Information

| | |
|---------------------|---------------------------|
| Dimensions (mm) | Ø: 140 x D: 45 mm |
| Barcode | 5055807627504 |
| Box Dimensions (mm) | L:150 x W: 150 x D: 55 mm |
| Units/Outer Carton | 40 |

| | |
|------------------------------|----------------------------|
| Outer Carton Barcode | 15055807627501 |
| Outer Carton Dimensions (mm) | L:630 x W: 305 x D: 320 mm |

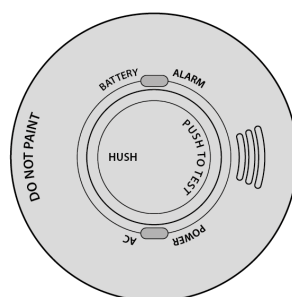

Ø140mm

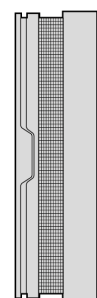

D45mm

Tel: 0114 279 8999 | Email: sales@redarrowelectrical.co.uk | redarrowelectrical.co.uk

Red Arrow Electrical Ltd, Cortonwood Drive, Brampton, Barnsley, S73 0UF

This document is uncontrolled if printed, all information is subject to change. Generated on 29/04/24